

#88 1745

Agreement among heirs of Major John Lane for division of his lands

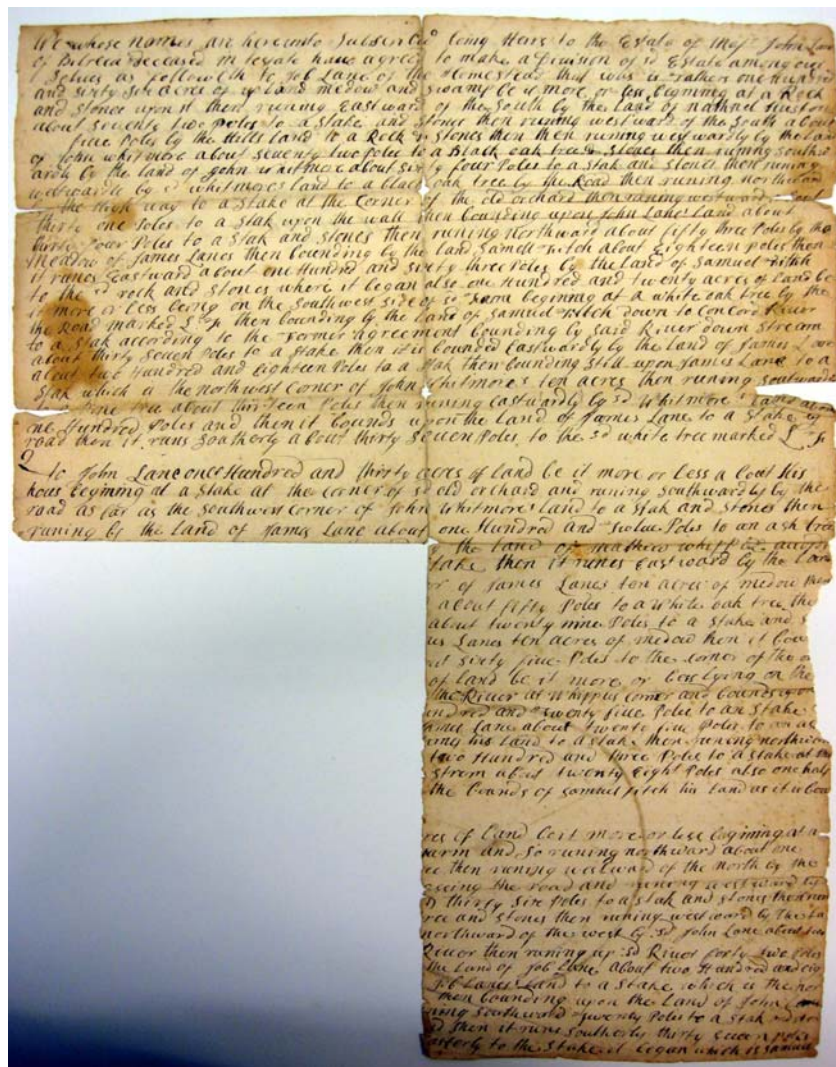

(This document is incomplete – there are only 3 of 4 quarters of the sheet)

We whose names are hereto subscribed being heirs to the Estate of Major John Lane of Bilreca deceased intestate have agreed to make a Division of said Estate among our selves as followeth to **Job Lane** of the Homestead that was his fathers one hundred and sixty six acres of upland meadow and swamp be it more or less beginning at a Rock and stone upon it then running eastward of the south by the land of Nathanel Huston about seventy two poles to a stake and stones then running westward of the south about five poles by the Hills land to a rock & stones then then running westward by the land of John Whitmore about seventy two poles to a black oak tree & stones then running southwardly by the road marked £:sp then bounding by the land of Samuel Fitch down to Concord River to a stake according to the former agreement bounding by said river down stream about thirty seven poles to a stake then it is bounded eastwardly by the land of James Lane about two hundred and eighteen poles to a stake then bounding still upon James Lane to a stake which is the Northwest Corner of John Whitmore's ten acres of land be it more or less a coal his heirs old orchard and running southwardly by the road as far as the southwest corner of John Whitmore's land to a stake and stones then running by the land of James Lane about one hundred and twelve poles to an ash tree the land of Nathanel Huston's meadow and stones then it runs eastward by the land of James Lane ten acres of meadow then about fifty poles to a white oak tree then about twenty nine poles to a stake and stones then running northward by the land of Samuel Fitch about eighteen poles then it runs eastward about one hundred and sixty three poles by the land of Samuel Fitch to the sd rock and stones where it began a;sp pme hundred and twenty acres of land be it more or less being on the southwest side of sd Farm beginning at a white oak tree by the the road marked £:sp then bounding by the land of Samuel Fitch down to Concord River to a stake according to the former agreement bounding by said river down stream about thirty seven poles to a stake then it is bounded eastwardly by the land of James Lane about two hundred and eighteen poles to a stake then bounding still upon James Lane to a stake which is the Northwest Corner of John Whitmore's ten

acres then running southward to a pine tree about thirteen poles then running eastwardly by sd Whitmore's land about one hundred poles and then it bounds upon the Land of James Lane to a stake by road then it runs southerly about thirty seven poles to the sd white tree marked £ Tr

To **John Lane** one hundred and thirty acres of land be it more or less about his hous beginning at a stake at the center of sd old orchard and running southwardly by the road as far as the southward corner of John Whitmores land to a stake and stones then running by the land of James Lane about one hundred and twelve poles to an ash tree  
*(This completes the top 2 quarters – the following is the bottom right quarter)*

y the land of Matthew Whipple according stake then it runs eastward by the land or of James Lanes ten acres of meadow then about fifty poles to a white oak tree then about twenty nine poles to a stake and s mes Lane ten acres of medow then bou ut sixty five poles to the corner of the or of land be it more or less lying on the the River at Whipples corner and bounds upon nd red and twenty five poles to an stake James Lane about twenty five poles to an as ames his land to a stake then running northward two hundred and three poles to a stake at the stream about twenty eight poles also one half the bounds of Samuel Fitch his land as it is bou

res of land be it more or less beginning at a arm and so running northward about one ee then running westward of the north by thes ossing the road and running westward by

## The Lane Family Papers

## Bedford Historical Society

thirty six poles to a stake and stones then run  
ree and stones then running westward by the la  
northward of the west by sd John Lane about two  
River then running up :sd River forty two poles  
the land of Job Lane about two standred and eig  
Job Lane s land to a stake which is the nor  
then bounding upon the land of John Lane  
ning southward twenty poles to a stake and stones  
ad then it runs southerly thirty seven poles  
asterly to the stake it began which is Samuel

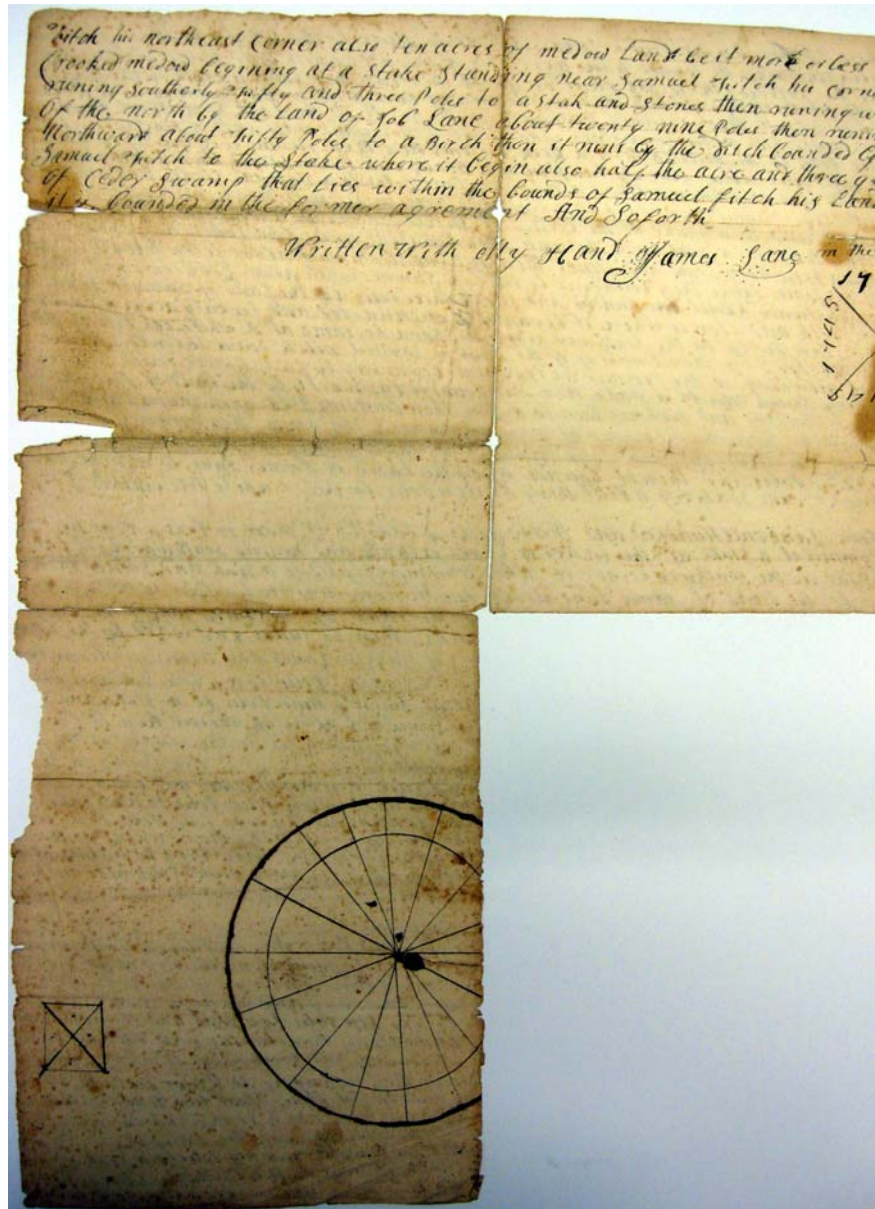

Fitch in the northeast corner also ten acres of meadow Land be it more or less in crooked meadow beginning at a stake standing near Samuel Fitch his corner then running southerly fifty and three poles to a stake and stones then running westwardly of the north by the land of Job Lane about twenty nine poles then running northward about thirty poles to a birch then it runs by the ditch bounded by Samuel Fitch to the stake where it begin also half the acre and three quarters of cedar swamp that lies within the bounds of Samuel Fitch his land as it is bounded in the former agreement and so forth

Written with my hand James Lane in the year 1745